

This document contains:

- The Event Covid-19 risk assessment and risk mitigation plan in accordance with the [FEI Policy for Enhanced Competition Safety during the Covid-19 Pandemic](#)
- The Event Approved Schedule

Given the current covid-19 situation, please note that the FEI's approval of a Schedule should not be taken as an absolute guarantee that the Event will definitely go ahead. The decision whether the Event can take place must be made by the OC and NF in close consultation with the applicable domestic government and public health authorities. It is the responsibility of each Participant to check the status of the Event prior to planning his/her travel to the Event.

Risk assessment for COVID-19

The questions below will enable OCs to review the additional considerations specific to sports, and thus inform their risk assessment of COVID-19 associated with their Event. This will help OCs understand and manage any additional risk from COVID-19.

The risk assessment should be reviewed and reassessed regularly during the planning phase and updated immediately prior to the transition to the operational phase, especially in light of the rapidly evolving nature of the outbreak. Reference should be made to the latest technical guidance and situation reports on the WHO website.

The risk assessment for COVID-19 associated with the Event must be coordinated and integrated with the host country's national risk assessment for COVID-19. The person completing the questionnaire should include input from the local public health authorities, consult WHO's latest technical guidance and ensure that there is an up-to-date evaluation of the epidemiological situation.

Please answer Yes (1) or No (0) to the following questions to determine a risk assessment score that incorporates factors specific to sporting events

Additional risk of COVID-19 to the sporting event	Yes (1)/No (0)	Score
Will the event be held in a country that has documented active local transmission of COVID-19 (community spread)?	1	1
Will the event be held in a single venue or multiple venues/cities/countries? <i>(single venue = 0; multiple venues = 1)</i>	0	0
Will the event include international participants (athletes and spectators) from countries that have documented active local transmission of COVID-19 (community spread)? <i>(NB: if the Events does not involve spectators, please clarify this in the comments to the questions in relation to spectators in the "Mitigation Checklist" sheet)</i>	1	1
Will the event include a significant number of participants (athletes or spectators) at higher risk of severe COVID-19 disease (e.g., people over 65 years of age or people with underlying health conditions)?	0	0
Will the event include sports that are considered at higher risk of spread for COVID-19 (eg, contact sports)?	0	0
Will the event be held indoors? <i>(Yes = 1; No = 0)</i>	0	0
Total COVID-19 risk score		2

Mitigation checklist for COVID-19

Mitigation measures assess the current effort and planning to reduce the risk of spread of COVID-19 disease for the event. As mitigation measures can reduce the overall risk of the sporting event contributing to the spread of COVID-19, they should be taken into account after the risk assessment has occurred to gain a clearer understanding of the overall risk of transmission and further spread of COVID-19, should the event be held. Together with the risk assessment score, the mitigation measure will contribute to the decision matrix and influence the assessment of the overall risk of transmission and further spread of COVID-19 in relation to the event.

Topic	Key consideration	Score Yes/Completed (2), Maybe/In progress (1), No/Not considered (0)	Weighting	Total score	Comments
Understanding of the overview of the current COVID-19 situation by the OC	Have the relevant OC and responsible staff been informed about the latest available guidance on the COVID-19 outbreak (official web resources available from WHO, CDC, ECDC, UN, local public health authorities)? And are the OC and staff concerned committed to following the available guidance?	2	1	2	
	Is the OC aware of global and local daily situation reports as provided by WHO or local public health authorities?	2	1	2	
	Do the OC and responsible staff understand the risks and transmission routes of COVID-19, the steps that Event attendees can take to limit spread, the recognized best practices (including respiratory etiquette, hand hygiene, physical distancing, etc.), and the travel restrictions adopted by different countries that may affect the Event?	2	1	2	
Event emergency preparedness and response plans	Has a contingency medical response plan for COVID-19 been developed for the Event?	2	3	6	
	Does the contingency medical response plan include information about how attendees should interact with the host country healthcare system (e.g. hotline/helpline telephone number, medical teams and first-aid points for the Event, local health care system)?	2	3	6	
	Is there an Emergency COVID-19 Outbreak Response Coordinator/Team in the OC or other structure structure for the Event with defined roles and responsibilities, coordinating the health preparedness and response planning for the outbreak?	2	2	4	
	Has the host country or OC requested support from WHO and/or local public health authorities ?	2	3	6	
	Has the OC acquired the following supplies to help reduce the risk of transmission of COVID-19?				
	Personal protective equipment (e.g. masks, gloves, gowns) for onsite medical personnel	2	3	6	
	Hand sanitizer and alcohol rubs/gels, tissues, frequently replaced soap canisters and closed bins for safe disposal of hygienic materials (e.g. tissues, towels, sanitary products) in washrooms and changing rooms	2	3	6	
Hand sanitizers and alcohol rubs for all entrances and throughout the venue	2	3	6		

If a person feels unwell/ shows symptoms of an acute respiratory infection during the Event:					
Is there a procedure for athletes or spectators to clearly identify whom to contact and how to do so if they or other Event participants feel unwell?	2	3	6		
Is there a protocol on whom the OC should contact in the host country to report suspected cases and request testing and epidemiological investigations?	2	3	6		
Are first-aid services or other medical services in-place and equipped to support patients with respiratory symptoms?	2	2	4	We'll have an equipped ambulance at the showground and if needed the patient will be moved to the nearest Hospital that is located only 5 minutes from the facilities.	
Are there isolation rooms or mobile isolation units available onsite?	0	2	0	They should go to the relevant health authority.	
Are there any designated medical facilities that manage patients with COVID-19 infection in the host country?	2	2	4		
Are there transportation services with trained medical professionals available to transport critically ill patients with severe acute respiratory infections to a hospital or to evacuate them from the host country, if necessary?	2	2	4		
Has a cleaning schedule been developed to ensure the venue is clean and hygienic – wiping surfaces and any equipment regularly with disinfectant is strongly recommended (before, during and after the event and between each round of competition)?	2	3	6		
Are there established screening measures , including temperature checks in place for participants at the point of entry, venues, routes and on-site medical facilities (first-aid points)? (Please specify in Comments what these screening measures include)	2	3	6	The temperature of everyone will be taken at the arrival to the showground.	
Is the host country conducting COVID-19 laboratory diagnostic tests ? (If Yes, please specify in comments the type of COVID-19 diagnostic test used)	2	3	6		
Does the host country have a national public health emergency preparedness and response plan that can address severe respiratory diseases, including COVID-19?	2	2	4		
Is there a preliminary agreement by the host country to provide care for any COVID-19 cases connected with the Event?	1	3	3		
If the Event is for a duration of 14 days or longer, does the medical response plan for the event include resources and protocols for managing all public health interventions that would be necessary and supporting the national public health authorities if participants are infected and become unwell at the Event? (If the event is for less than 14 days, please score 0)	0	3	0		
If the Event is for less than 14 days, does the medical response plan include protocols for OCs to notify all participants of possible exposure to COVID-19 if the OCs are made aware of any suspected or confirmed cases that attended the Event? (If the event is for 14 days or longer, please score 0)	2	3	6		
Stakeholder and partner coordination	Is there an established mechanism for collaboration and coordination between the health and security sectors , which is considered as crucial?	2	2	4	
	Are there agreed, clear and easily understood processes in place for reporting to external multi-sectoral stakeholders (including surveillance authorities, WHO, CDC, ECDC, etc.) and disseminating risk communication messages (Media)?	2	2	4	

Command and control	Is there a decision-making authority/body and an agreed procedure to modify, restrict, postpone or cancel the Event related to the evolving COVID-19 outbreak?	2	3	6	
	Are there arrangements to activate a strategic health operations centre if there are suspected COVID-19 cases in connection with the Event?	2	2	4	
	Have the OC and staff undergone training and exercises on personal safety procedures and emergency mitigation measures (including those specifically listed in this checklist)?	1	3	3	
Risk communication	Is there a risk communication strategy for the Event in regard to COVID-19?	2	3	6	
	Is there a designated person(s) to lead media activities and tasked with managing all external communications with national and international government officials, the general public, and the media? (If yes, please identify the spokesperson in comments)	2	2	4	
	Has there been monitoring of national and international media and social media established for rumours to be able to counter them early? (Please explain in the comments what protocols are in place for counter messaging)	2	2	4	
	Has coordination been set up with major official media channels and social media sites such as Twitter, Facebook and Instagram so that messaging can be coordinated with, and assisted by, the platforms to provide targeted messaging from OCs (including messaging to counter fake news and rumours, and proactive messaging about the status of the sporting event, including changes)?	2	2	4	
Public health awareness of COVID-19 before and during the event	Has public health advice on clinical features of COVID-19, preventive measures, especially respiratory etiquette, hand hygiene practices, and physical distancing, been shared with all staff involved in the Event, athletes, the public, and personnel of all relevant stakeholders?	2	3	6	
	Has information on the at-risk populations been provided to all athletes, the public and others so they may make an informed decision on their attendance based on their personal risks?	2	3	6	
	Has public advice included information on the meaning of the following measures: quarantine, self-isolation and self-monitoring ?	2	2	4	
Surge capacity	Are there any surge arrangements in place in the event of a public health emergency during the Event - (i.e. suspected and confirmed cases of COVID-19)?				
	Do these surge arrangements include funding for mitigation measures?	2	3	6	
	Do these surge arrangements include stockpiles of equipment (e.g. personal protective equipment, etc.)	2	3	6	
	Do these surge arrangements include training of extra staff?	2	2	4	
	Do these surge arrangements include volunteers?	0	2	0	
	Will there be daily health checks of athletes/competitors?	2	2	4	On arrival at the showground the temperature of each athlete will be taken.
	Will the athletes be separated from other groups , such as officials, support staff and spectators, to limit transmission?	2	2	4	
	Are there measures in place to limit the sharing of equipment, water bottles, towels, etc. ?	2	3	6	

Specific mitigation measures	Will athletes be given closed containers to allow for the safe disposal or storing of all hygienic materials (e.g. tissues, towels, etc.)?	2	3	6	
	Will the Event have designated seating for all spectators?	2	3	6	
	Does the designated seating provided allow for physical distancing between spectators (minimum of 1 metre)?	2	2	4	
	Have pre-travel health checks been performed on all athletes to ensure underlying co-morbidities, medications, allergies, etc. are documented?	0	2	0	

Sum of mitigation measures	202
Total mitigation score (%)	92

202

Event overall risk score

The decision matrix takes the risk score and the mitigation score to provide a colour determination. This colour determination identifies the total risk of transmission and further spread of COVID-19 in relation to the Event. The "Colour Determination" key below the decision matrix describes the total risk for each colour.

Total COVID-19 risk score (from "Risk Assessment" Tab)	2
--	---

Total mitigation score (from "Mitigation Checklist" Tab)	92
--	----

Risk Vs. Mitigation Matrix

Total Risk Assessment Score	Very Prepared to Mitigate COVID-19 Impacts (76-100)	Somewhat Prepared to Mitigate COVID-19 Impacts (51-75)	Somewhat Unprepared to Mitigate COVID-19 Impacts (26-50)	Very Unprepared to Mitigate COVID-19 Impacts (0-25)
0 - Negligible	Very low	Very low	Very low	Very low
1 - Very Low Risk	Very low	Very low	Low	Low
2 - Low Risk	Low	Low	Low	Moderate
3 - Moderate Risk (low-moderate)	Low	Moderate	Moderate	Moderate
4 - Moderate Risk (high-moderate)	Moderate	Moderate	High	Very High
5 - High Risk	High	High	Very High	Very High
6 - Very High Risk	Very High	Very High	Very High	Very High

KEY FOR COLOUR DETERMINATION OF OVERALL RISK	
VERY LOW	Overall risk of transmission and further spread of COVID-19 in relation to the Event is considered <u>very low</u> .
LOW	Overall risk of transmission and further spread of COVID-19 in relation to the Event is considered <u>low</u> . Recommend checking whether mitigation measures can be strengthened.
MODERATE	Overall risk of transmission and further spread of COVID-19 in relation to the Event is considered <u>moderate</u> . Recommend <u>significant</u> efforts to improve mitigation measures or reduce risk of transmission (decrease risk assessment score).
HIGH	Overall risk of transmission and further spread of COVID-19 in relation to the Event is considered <u>high</u> . Recommend <u>significant</u> efforts to improve <u>both</u> mitigation measures and reduce risk of transmission (decrease risk assessment score).
VERY HIGH	Overall risk of transmission and further spread of COVID-19 in relation to the Event is considered <u>very high</u> .



SUNSHINE TOUR

since 1994

PROTOCOL for the CAI3*H1-CAI2*H2/4-CAI2*ChP1 at DEHESA MONTENMEDIO 2021 5th-7th of November

1

The following protocols and procedures will be established ensuring that the Sunshine Tour S.L. safely hosts this competition here at Montenmedio. Horse numbers have been limited. Thanks to the large size of our facilities and the experience of our showground teams, adequate safety measures are in place that minimise risks associated with COVID-19 transmission and that follow the guidelines set up by the Higher Sports Council and the Spanish Royal Federation Spanish of Horse Riding.

1.GENERAL COVID-19 RULES:

- The competition will be open **for the public, respecting the capacity limitations set out in the current measures of the Spanish Government.** The public will only have access to the grandstands and restaurants area.
- On arrival at the showground your temperature will be taken. Should it exceed 38 degrees centigrade you will be asked to leave the facilities and placing yourself in immediate contact with the relevant health services.
- **The use of the masks will be required inside of the buildings. All persons on the outside of the venue must wear a mask ONLY if the safety distance of 1.5m cannot be respected** (masks will be on sale at the Show Office).
- **All persons on the venue should respect the safety distance of 1.5m between others.**
- We encourage to **limit your physical social contacts.**
- There will be **air purifier anti COVID-19** in all the restaurants, toilets, and offices.
- There will be regular disinfection of all communal areas during the day (bathrooms, stable areas, showers etc).
- **Hydro-alcoholic gels** will be available throughout the facilities, and you will be expected to use these regularly to sanitize your hands when you access any area, such as the stables, the horse showering stations, the bathrooms and showers, restaurants, the Show Office, judges boxes and the warm up areas. There will be regular ventilation of closed spaces including the warehouses, restaurants, offices, bathrooms, showers and judges boxes etc.
- **In the case that you experience any symptoms related to Covid-19 you must cancel your entries and may not attend.**
People who develop symptoms on site must inform the OC immediately. This will enable the OC to alert the authorities responsible for contact tracing.

2. BEFORE TRAVELLING TO THE SUNSHINE TOUR/ ON ARRIVAL AT THE SHOWGROUND:

➤ **Before travelling to the Sunshine Tour:**

As per the EHV-1 By-Laws, it is now mandatory to use the **FEI HorseApp** mobile application to:



SUNSHINE TOUR

since 1994

- Enter the temperature of each horse twice daily for the **three days** ~~10 days~~ leading up to the arrival at the event.
For clarification, the 3 days prior to your arrival at the Event are calculated as per this example: If you plan to arrive at the Event on the Thursday, you will have to enter the temperatures for the three preceding days, which are Monday, Tuesday and Wednesday.
- Fill in a Horse Health FEI Self-Certification form for all horses attending the event.
This should not be done earlier than 24 hours prior to your arrival at the Event
- **It will be necessary to communicate the date and time of arrival of the horses to the showground to the OC at least 2 days in advance.**
 - ✓ We would also like to remind you to bring your own thermometer to the event as you will have to take the temperature of each horse after unloading them and twice a day during the event.

2

As of 1 November 2021, the EHV-1 By-Law Sanction system are in full force.

➤ On arrival at the showground:

- On your arrival the horses will be placed in their assigned stables by our Stable Manager. You should wait to the veterinarian that will come and check your horses.
- If your horses are deemed acceptable by the vet, you may unload your equipment.
- Passports and travel permits will be passed to the Stable Manager.
- Once documents have been passed to the Show Office you will be provided your competition numbers.
- In order to gain access the stable area **accreditation will be required**. We would like to ask all drivers to **send us the details (address, identity card number, telephone number & e-mail address)** from the members of your team **before the 3rd of November**. We will provide you, on arrival at the showground an accreditation wristband.

3. STABLE AREA:

- We recommend that everyone takes the utmost care to sanitize their own allocated areas.
- Hydrogels will be available both at the entrances to the stable areas and at the horse shower areas.
- The horse showers will be regularly sanitized by our staff. The use of the hydrogel before using these facilities is obligatory.

4. SECRETARY:

We must stress that you may only come to the Show Office if absolutely essential and unavoidable.

- There will be a limit number of people in each Office at any one time. Each secretary will attend only one person at a time, on this front we strongly recommend that you do not come to the office in groups but send a delegated person.
- You can contact the show / accounting office as follows:



SUNSHINE TOUR

since 1994

- Show Office: +34 956 447 125 (Ext.1) / +34 649 293 273 (WhatsApp) - sunshinetour@sunshinetour.net
- Accounting Office: +34 956 447 125 (Ext.2) / +34 673 35 26 01 (WhatsApp) - contabilidad@sunshinetour.net

3

- **Following the BOE guidelines contactless payments should be made.**
- Applications for **health papers** need to be done at the Show Office as latest **on Thursday the 4th of November before 12:00 p.m.** It will be necessary to provide the entry health papers.

5. WARM UP ARENAS:

- Each competition arena will have a specific warm up arena.
- Access to the arenas will be controlled at all times, only **5 carriages** that are entered in the current /relevant class will be allowed entry.
- There will be 1 arena for free access for training every day.
- Only **ONE** person per driver may enter the warm up arenas.

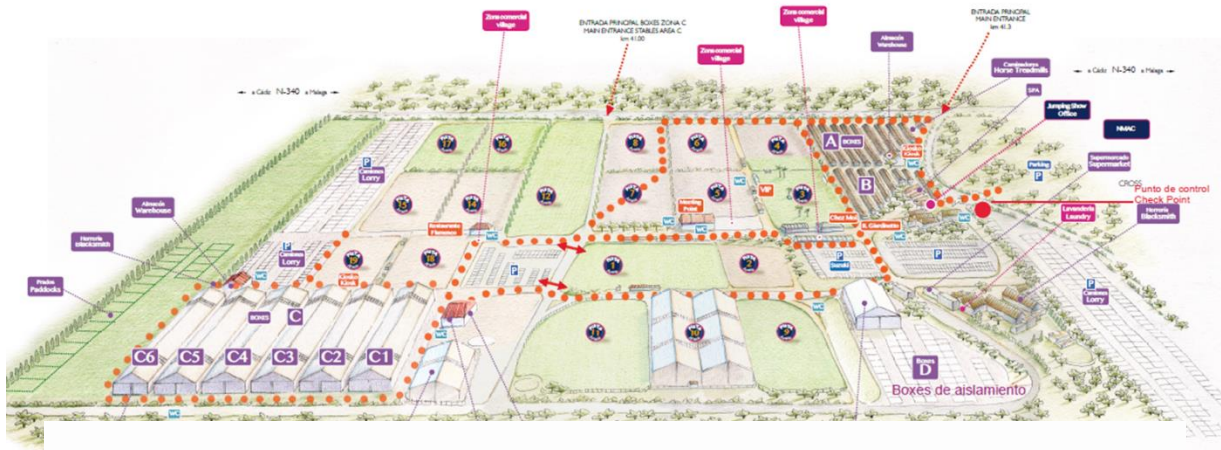

6. MEETINGS/RESTAURANTS

- ✓ **Restaurants will be open and will comply with the current regulations at the time of the celebration of the event.**

01/11/2021



SUNSHINE TOUR

since 1994

PROTOCOLO CAI3*H1-CAI2*H2/4-CAI2*ChP1 DEHESA

MONTENMEDIO 2021

Del 5 al 7 de noviembre

4

Los siguientes protocolos y procedimientos se establecerán para que Circuito Hípico del Sol, S.L. celebre sus próximos concursos de forma segura. Hemos limitado el número de caballos y gracias a la dimensión de la instalación, así como a la experiencia de nuestro equipo se proporcionan las adecuadas condiciones para el desarrollo de la competición siguiendo con las directrices marcadas por el Consejo Superior de Deportes y la Real Federación Hípica Española para evitar los riesgos asociados con la COVID-19.

1. NORMAS GENERALES COVID-19:

- Se autorizará el acceso del **público general** a la instalación, respetando las limitaciones de aforo marcadas en la normativa vigente. El público sólo tendrá acceso a la zona de gradas y restaurantes.
- A su llegada a la instalación se le tomará la temperatura y si esta es superior a 38 grados deberá abandonar la instalación de inmediato y ponerse en contacto con las autoridades sanitarias competentes.
- **Será obligatorio el uso de mascarillas en todo momento en el interior y, en el exterior sólo en el caso de que no pueda respetarse la distancia mínima de seguridad de 1.5m.**(Dispondremos de mascarillas para la venta en la Show Office).
- **Será obligatorio respetar la distancia de seguridad de 1.5m.**
- Se recomienda **limitar el contacto físico** con otras personas.
- Dispondremos de un **sistema purificador de aire anti-COVID-19** en todos los restaurantes, aseos y oficinas.
- Se desinfectarán varias veces al día las zonas de uso común de toda la instalación (baños, zona de boxes, duchas, etc.).
- Dispondremos de **geles hidroalcohólicos** en toda la instalación con los que deberán desinfectarse las manos con frecuencia; los accesos a la zona de boxes, duchas para los caballos, accesos a los aseos y duchas, entradas a los restaurantes, oficina del concurso, casetas de jurado, así como en las pistas de calentamiento.
- Se realizarán tareas de ventilación periódica en los espacios cerrados tales como almacén, restaurantes, oficinas, baños, duchas, casetas de jurado, etc.
- **En caso de tener síntomas compatibles con la enfermedad se les ruega que cancelen sus inscripciones y no acudan al evento.**
 - **Si alguna persona presenta síntomas deberá informada al CO inmediatamente. De este modo el CO podrá informar a las autoridades competentes responsables.**

2. ANTES Y DESPUÉS DE LA LLEGADA A LA INSTALACIÓN:

- Antes de la llegada al concurso:



SUNSHINE TOUR

since 1994

- De acuerdo con los estatutos de EHV-1, es obligatorio utilizar la aplicación móvil **FEI HorseApp** para:
 - o Toma y registro de temperatura de los caballos 2 veces al día durante los **3 días 10 días previos** a la llegada al concurso.
Por ejemplo, si tenéis pensado llegar al evento el jueves debéis registrar las temperaturas desde el lunes.
 - o **Cumplimentar el formulario "Horse Health FEI Self-Certification"** para todos los caballos que asistan al evento.
Este formulario no debe cumplimentarse antes de las 24 horas anteriores a la llegada al concurso.
 - o **Será necesario comunicar fecha y hora de llegada de los caballos a la instalación al CO con una antelación mínima de 2 días.**
- ✓ Se recuerda que deben traer su propio termómetro para la toma de temperatura de los caballos tanto a la llegada como durante el evento (2 veces al día).

5

A partir del 1 de noviembre de 2021, el sistema de sanciones EHV-1 de la FEI está en pleno vigor.

➤ Llegada al concurso:

- A su llegada a la instalación los caballos serán ubicados en los boxes asignados por nuestro jefe de cuadras, dónde deberán esperar a que el veterinario responsable realice el examen clínico a los mismos.
- Una vez que el veterinario acredite que los caballos se encuentran en buen estado de salud podrán descargar el material de los camiones y deberán hacer entrega de pasaportes y guías al jefe de cuadras.
- Una vez entregada la documentación, la oficina del concurso tendrá preparados los dorsales y podrán pasar a recogerlos.
- **La acreditación siempre será necesaria para acceder a la zona de cuadras** y por ello rogamos a todos los cocheros que nos envíen los datos personales (dirección, número de DNI o Pasaporte, número de teléfono y dirección de correo electrónico) de todos los miembros del equipo **antes del miércoles 3 de noviembre.** De este modo, os haremos entrega de las acreditaciones a vuestra llegada a la instalación.

3. ZONA DE BOXES:

- Recomendamos que todos contribuyan a desinfectar su propia zona de boxes.
- Dispondremos de hidrogel en la entrada a la zona de cuadras y en las zonas de ducha de los caballos.
- La zona de duchas para caballos será desinfectada frecuentemente por nuestro personal y será obligatoria la desinfección de las manos con hidrogel antes del uso de estas.

4. SECRETARÍA:

Aconsejamos sólo venir a la oficina en casos de extrema necesidad e intentar hacer todos los trámites vía telemática.



SUNSHINE TOUR

since 1994

- El aforo máximo de la oficina estará limitado en número de personas. Cada secretaria atenderá a una sola persona, por lo que se les recomienda que no vengan en grupos de varias personas.
 - **Podrán contactar con la oficina del concurso/contabilidad:**
 - **Oficina del concurso/Show Office: +34 956 447 125 (Ext.1) / +34 649 293 273 (WhatsApp) - sunshinetour@sunshinetour.net**
 - **Oficina de contabilidad/Accounting Office: +34 956 447 125 (Ext.2) / +34 673 35 26 01 (WhatsApp) - contabilidad@sunshinetour.net**
-
- ***Siguiendo con las directrices publicadas en el BOE los pagos deberán realizarse con medios que no supongan contacto físico.***
 - Para poder solicitar las **guías de transporte** será requisito indispensable hacer entrega de la guía de entrada, así como de la solicitud correspondiente incluyendo todos los datos de la partida como máximo el **jueves día 4 antes de las 12.00 p.m.**

5. PISTAS DE ENSAYO:

- Cada pista de competición tendrá su correspondiente pista de ensayo.
- Habrá un control de acceso a las pistas donde solo se permitirán **5 coches** de la prueba que se esté disputando.
- Cada día habrá una pista libre para trabajar.
- A la pista de ensayo podrá acceder tan solo 1 persona por cochero.

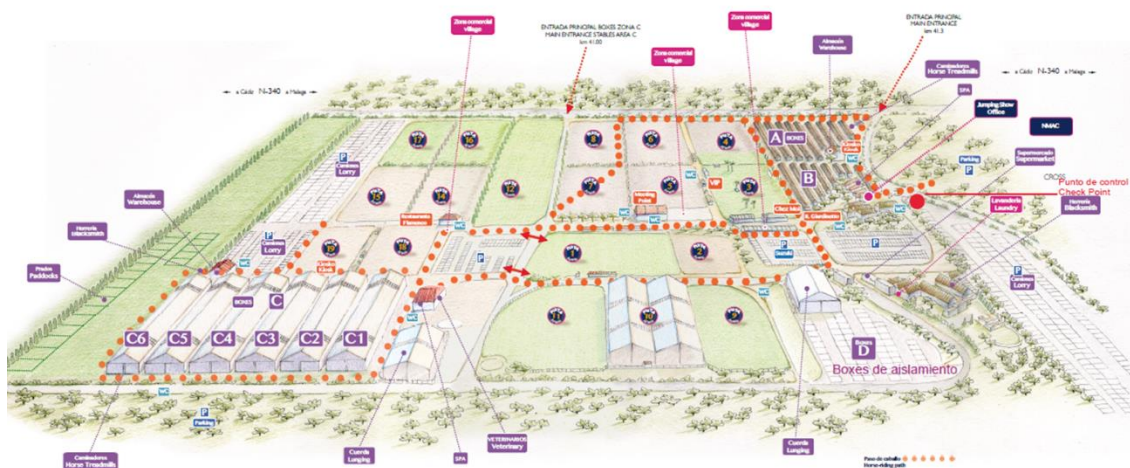

6. REUNIONES/RESTAURANTES

- **Los bares y restaurantes se registrarán por la normativa vigente según el nivel de alerta en Andalucía en el momento de la celebración del evento.**

01/11/2021



SUNSHINE TOUR

since 1994

EHV-1 Action Protocol and Contingency Plan for the CAI3*H1-CAI2*H2/4-CAI2*ChP1, Dehesa Montenmedio, 2021

1

The following **Biosecurity, Action Protocol and Contingency Plans** are set up in order to safeguard the attendees of the next events held at the Sunshine Tour, S.L. Horse numbers have been limited and thanks to the size of the installations as well as the experienced team running them, we are able to meet the conditions set forward by the Federación Ecuestre Internacional (FEI) and the Real Federación Hípica Española (RFHE) to avoid risks associated with the EHV-1.

- **Action Protocol:**

- Arrival at the event.

- During the Event.

- **Contingency Plan:**

- Isolation Zone.

- Access to the Isolation Zone.

- Horse stabling.

- Hospitals/laboratories.

- **Appendix:**

- Installation Plan.



SUNSHINE TOUR

since 1994

1. ACTION PROTOCOL

2

Arrival at the event:

1. **Lorry reception** will take place at the **Control Point** by the **Stable Manager**.
2. **Horses** will be examined by the 'elected' Veterinarian.
 - Lorries will be directed by the Stable Manager, to their assigned stabling where the following checks will be carried out:
 - Horses are correctly placed in their assigned stables.
 - Horse **microchips** will be read and checked with their Passports.

The passports will be validated, FEI, LICs, DIE & Tarjeta Validación Deportiva, along with any other incidental documentation.
Vaccine dates will be checked to ensure each horse is up to date with obligatory vaccinations such as Equine Flu.
 - Clinical horse examination:
 - Each horse will have its temperature taken by the rider/groom and this will be recorded by the elected veterinary, who will note down the temperature in the FEI HorseApp.
 - Heart and breathing rates will be recorded along with the presence of any other symptoms, such as cough, lymph node infarction, etc.
 - If the horse's temperature is over 38.5°C, taking into account ambient temperatures and the conditions during transit to the installations, the horse will be rechecked after one hour of rest. If the horse then tests as equal to or below 38.5°C the horse will be accepted and may be installed in its assigned stable.
 - In the case that the horse's temperature continues to be above 38.5°C the **Contingency Plan** will be put in to operation. Firstly, the horse and all of the horses travelling on the same vehicle (same origin), will be moved to the Isolation Zone. The Contingency plan is outlined in the second part of this document.
 - If the horse's temperature is normal on the following day and it is verified that the horse does not present any other infectious symptoms, the animal will be transferred to its assigned stable.
3. The horse's **passport** and health papers, will be collected by the stable manager and delivered to the Show Office.

NOTE: The responsible veterinarian will have both disposable equipment ready to examine groups of horses (from the same origin / transport vehicle), as well using and



SUNSHINE TOUR

since 1994

carrying out thorough cleaning and disinfection of all standard medical tools before use between horses (eg: thermometer, stethoscope ...)

▶ [Horse Arrival procedure.pdf \(fei.org\)](#)

3

During the event:

1. Stable areas:

- ✓ Horses will be stabled in open air, in fixed boxes with a height of 2.30m permitting good ventilation in the stables. (Stable areas; A and B).
- ✓ Horses will be assigned boxes corresponding to their zone of origin, transport / previous stabling etc; but with sufficient separation between one and another.
- ✓ All stables will be cleaned, disinfected and sealed before the arrival of the horses to the installations.
- ✓ Hydrogel is available at the entrances to the stabling areas and horse showering areas.
- ✓ Every evening, shared areas, the horse showers and the walkways in the stabling areas will be disinfected by our stable staff.

2. The temperature of each horse must be take twice daily (morning and evening) by the rider or groom and must be noted down in the **FEI HorseApp**. ~~the Temperature Control Sheet which will be provided by the Organising Committee (OC) for each horse participating in the event. The temperature control sheet must be visible and placed in the front part of each stable, for easy recognition and verification of data by veterinarians and all other officials.~~

3. In the case of suspicious symptoms arising during the event (fever etc):

- ✓ The horse will be immediately isolated to a designated Isolation box.
- ✓ Any horses in its contact group will be clinically contained and placed under observation.
- ✓ The Autoridad Sanitaria Local (Local Health Authority) and the Comité Técnico Nacional Veterinario de la RFHE (National Technical Committee) will be immediately notified by the OC and the designated Official National Veterinarian.
- ✓ Relevant procedures will be taken and the Contingency Plan brought into action.



SUNSHINE TOUR

since 1994

2. CONTINGENCY PLAN

4

1. Isolation Zone:

- ✓ There will be an Isolation Zone which will be more than 50m away from the main stabling area (Stable area D).
- ✓ Stables in this area will be carefully cleaned and disinfected constantly by our staff.
- ✓ There will be a sufficient number of boxes available proportional to the number of horses attending the event. A minimum of 3m will be kept between the rows of stables.
- ✓ There will be a box with hoist available in the isolation area.
- ✓ These stables have good ventilation channels.
- ✓ Pets are prohibited in the isolation area.

2. Access to the Isolation Zone:

Only those in charge of the care of an isolated horse may enter the Isolation Zone.

3. Horse Stabling:

- ✓ Horses that travelled together will be placed together in the same group but with sufficient separation between each of them.
- ✓ Each horse will have a separate tack area specifically for that individual horse, to prevent cross contamination of other horses by sharing of materials.
- ✓ ~~Temperature Control Sheets must be visible, placed on the front of each stable charts.~~ Rectal temperature should be taken twice each day, morning and evening **and must be noted down in the FEI HorseApp.**
- ✓ Hand disinfection points will be placed at the entrance / exit of the Isolation Zone and there will be an area to change clothes and shoes before exiting the Zone.
- ✓ There will be a plan of the Isolation Zone area which will be filled in to show each horse's details, any extra data and contact information.

4. Care and Monitoring of Isolated horses:

- a) Rectal temperature should be taken twice daily during isolation by the person responsible for each horse's care. It is important to assess the general appearance of the horse (discharge from



SUNSHINE TOUR

since 1994

nostrils and eyes, any changes in the consistency and number of stools) and its wellbeing noted, any changes in water or feed consumption, how the horse is moving etc. If the horse presents any sign of symptoms the vet should be immediately called to attend.

- b) There will be a 24hr **treatment clinic** on call at the installations.
- c) In the case that a horse needs to be transported to the hospital we have a **horse ambulance solely reserved for the transport**.
- d) **PPE:** Specific equipment will be used for each horse in the isolation area. All equipment that is shared such as thermometers etc, will be disinfected between each and every horse. Materials that cannot be disinfected (brushes and sponges etc) will be for individual use with each horse.
Footwear and clothing, should be washed and disinfected after use with each horse, as well as coveralls and disposable gloves which should be carefully disposed of after each use.

5. Hospitals /Laboratories:

- ✓ **Hospital Veterinario de Referencia** → **Hospital de Referencia la Equina:** Apdo 110, C. Martagina, Km 1, 29692 Manilva, Málaga
- ✓ **Hospital de Referencia para casos de EHV-1** → **Hospital Clínico Veterinario UCO:** Campus Universitario de Rabanales. Ctra. Nacional IV-A, Km 396, 14014 Córdoba
- ✓ **Laboratorio EXOPOL** → Mailing of samples with PCR results returned in 24hrs.

▶ [EHV-1 - List of Laboratories 2021.pdf \(fei.org\)](#)

01/11/2021



SUNSHINE TOUR
since 1994

Protocolo de Actuación y Plan de Contingencia EHV-1 CAI3*H1-CAI2*H2/4-CAI2*ChP1 Dehesa Montenmedio 2021

1

El siguiente **Protocolo de Actuación y Plan de Contingencia en materia de Bioseguridad** ha sido elaborado para que Circuito Hípico del Sol, S.L. celebre sus próximos concursos de forma segura. Hemos limitado el número de caballos y gracias a la dimensión de la instalación, así como a la experiencia de nuestro equipo se proporcionan las adecuadas condiciones para el desarrollo de la competición siguiendo con las directrices marcadas por la Federación Ecuéstrea Internacional (FEI) y la Real Federación Hípica Española (RFHE) para evitar los riesgos asociados con el EHV-1.

1. Protocolo de actuación:

Llegada al concurso.

Durante el concurso.

2. Plan de Contingencia:

Zona de aislamiento.

Acceso a la unidad de aislamiento.

Estabulación de caballos.

Hospitales/laboratorios.

Anexo:

I. Plano de la instalación.



SUNSHINE TOUR

since 1994

1.PROTOCOLO DE ACTUACIÓN

2

Llegada al concurso:

1. **Recepción de camiones** en el **punto de control** por parte del jefe de cuadras.
2. **Examen de los caballos a la llegada** por parte del veterinario responsable.
 - Siguiendo las indicaciones del jefe de cuadras los camiones deberán dirigirse hasta los boxes asignados donde se les realizará el correspondiente examen:
 - a) Los caballos serán ubicados en los boxes correspondientes.
 - b) Verificación de la identidad del caballo a través de lectura de microchip e identidad en su Pasaporte.
Comprobación de validez de pasaporte FEI, LICs, DIE + Tarjeta Validación Deportiva y otras incidencias documentales.
Comprobación de las pautas de vacunación obligatorias contra influenza equina.
 - c) Examen clínico de los caballos:
 - Toma de temperatura por parte del mozo/jinete y registro de la misma por el veterinario responsable en la FEI HorseApp.
 - Además se examinarán frecuencia cardiaca, frecuencia respiratoria y registro de cualquier incidencia (tos, infartación ganglionar, etc).
 - Si la temperatura del caballo es superior a 38,5°C, teniendo en cuenta que una temperatura alta es compatible con las circunstancias del viaje, se someterá al caballo a una segunda toma de temperatura tras 1 hora de reposo. Si esta segunda toma de temperatura es inferior o igual a 38,5°C se aceptará al caballo y podrán instalarse en la zona asignada.
 - En caso de que la temperatura siga siendo superior a 38.5°C se procederá a trasladar al animal, así como al resto de caballos que lo acompañan en el vehículo de transporte hasta la zona de aislamiento y se pondrá en marcha el correspondiente Plan de Contingencia que se detalla en el segundo punto de este documento.
 - En caso de que la temperatura sea normal al día siguiente y se compruebe que el caballo no presenta ninguna otra sintomatología infecciosa se trasladará al animal a la zona de boxes asignada.
3. Recogida de los **pasaportes de los caballos** junto con sus guías sanitarias por parte del jefe de cuadras para entregarlas en la oficina del concurso.



SUNSHINE TOUR

since 1994

NOTA: El veterinario responsable dispondrá de equipos desechables para el examen entre grupos de caballos (mismo origen / vehículo de transporte), procediendo a la limpieza y desinfección de los utensilios de trabajo entre caballos (termómetro, fonendoscopio ...)

3

► [Horse Arrival procedure.pdf \(fei.org\)](#)

Durante el concurso:

1. Zona de cuadras:

- ✓ Los caballos serán estabulados en boxes fijos al aire libre de altura 2,30m, lo que permite una buena ventilación en la zona de cuadras (Zona de boxes A y B).
- ✓ Los caballos se distribuirán por zonas de origen en los boxes correspondientes, pero con la consiguiente separación entre unos y otros
- ✓ Los boxes serán desinfectados, limpiados y sellados antes de la llegada de los caballos a la instalación.
- ✓ Dispondremos de hidrogel en la entrada a la zona de cuadras y en las zonas de ducha de los caballos.
- ✓ La zona de duchas para caballos, así como los pasillos de la zona de cuadras serán desinfectadas cada noche por nuestro personal.

2. Toma de temperatura 2 veces al día (mañana y tarde) por parte del jinete/mozo y registro en la **aplicación FEI HorseApp. ~~hoja de control de temperatura que será proporcionada por el CO a cada caballo participante del evento.~~**

~~La hoja de control de temperaturas deberá dispuesta en la parte delantera del box para su fácil reconocimiento y comprobación de datos por veterinarios, comisarios y resto de oficiales.~~

3. Ante la presencia de una sospecha durante el transcurso del concurso (fiebre, etc):

- ✓ Aislamiento de forma inmediata del animal en el box de aislamiento designado.
- ✓ Contención clínica y delimitación del grupo de caballos de contacto.
- ✓ Comunicación inmediata a la Autoridad Sanitaria Local y al Comité Técnico Nacional Veterinario de la RFHE por parte del CO y del Veterinario Oficial Nacional designado.
- ✓ Toma de medidas y aplicación del plan de contingencia.



SUNSHINE TOUR

since 1994

2. PLAN DE CONTINGENCIA

4

1. Zona de aislamiento:

- ✓ Existirá una zona de aislamiento ubicada a más de 50 metros de la zona de cuadras (Zona de boxes D).
- ✓ Los boxes de la zona de aislamiento serán limpiados y desinfectados cuidadosamente y de forma constante por nuestro personal.
- ✓ Se dispondrá de un número de boxes suficiente y proporcional al número de caballos participantes. Se guardará una distancia mínima de 3 metros entre las líneas de los boxes.
- ✓ Se dispondrá de un box con polipasto en la zona de aislamiento.
- ✓ Existirán buenos canales de ventilación en los boxes.
- ✓ Se prohíbe el acceso de mascotas a la zona de aislamiento.

2. Acceso a la unidad de aislamiento:

Sólo podrán acceder al recinto las personas que estén al cuidado de los caballos aislados.

3. Estabulación de caballos:

- ✓ Estabulación conjunta de caballos que viajen en el mismo grupo, pero con la consiguiente separación entre unos y otros.
- ✓ Establecimiento de un guarnés específico del material de cada caballo para que no se junte con el del resto de caballos.
- ✓ ~~Hoja de temperatura fuera de cada box para el~~ registro de temperaturas rectales 2 veces/día en la **aplicación FEI HorseApp**.
- ✓ Puntos de desinfección de manos a la entrada/salida de la zona de aislamiento. Además, se habilitará una zona para cambiarse de ropa y calzado a la salida.
- ✓ Se elaborará un plano con la ubicación y datos de interés/contacto de los caballos en la zona de aislamiento.

4. Cuidado y seguimiento de caballos en aislamiento:

- a) La temperatura rectal de cada caballo deberá tomarse y registrarse dos veces al día durante el aislamiento por parte de la persona responsable de cada caballo. Además, será importante evaluar la apariencia general (secreción de ollares y ojos, cambios en la consistencia y número de heces), controlar la cantidad de



SUNSHINE TOUR

since 1994

agua y comida que consume el caballo y controlar como se mueve. Si el caballo presenta algún tipo de sintomatología deberá ser atendido por un veterinario.

- b) Habrá una **clínica de tratamiento** en la instalación operativa durante las 24 horas del día.
- c) En caso de que sea necesario llevar a algún caballo al Hospital dispondremos de **ambulancia exclusiva para realizar los traslados**.
- d) **EPI'S**: Se usará un equipo específico para cada caballo en la zona de aislamiento. Los equipos que sean de uso compartido, como, por ejemplo, ramales o termómetros, serán desinfectados entre caballo y caballo y aquel material que no pueda desinfectarse (cepillos y esponjas) será de uso exclusivo.

El calzado y la ropa, por ejemplo, deberá lavarse y desinfectarse después de cada uso, así como los monos y guantes desechables que deberán desecharse cuidadosamente después de cada uso.

5. Hospitales/Laboratorios:

- ✓ **Hospital Veterinario de Referencia → Hospital de Referencia la Equina:**
Apdo 110, C. Martagina, Km 1, 29692 Manilva, Málaga
- ✓ **Hospital de Referencia para casos de EHV-1 → Hospital Clínico Veterinario UCO:** Campus Universitario de Rabanales. Ctra. Nacional IV-A, Km 396, 14014 Córdoba
- ✓ **Laboratorio EXOPOL** para el envío de muestras PCR y obtención de los resultados en 24 horas.
- ✓
 - ▶ [EHV-1 - List of Laboratories 2021.pdf \(fei.org\)](#)

01/11//2021

I. DENOMINATION OF THE EVENT

Venue : CAI3* H1 - CAI2* H2/4 - CAICh2* P1 - Vejer de la Frontera

Dates : 5th - 7th November **NF:** ESP

Indoor: **Outdoor:**

EVENT CATEGORIES:

Seniors:

CAI2*-H4

CAI2*-H2

CAI2*-H1

CAI3*-H1

Children&Junior:

CAICh2*-P1

CAIJ2*-H1

II. GENERAL CONDITIONS

- FEI Statutes, 24th edition, effective 19 November 2019
- FEI General Regulations, 24th edition, 1st January 2020, updates effective 1st January 2021
- FEI Veterinary Regulations, 14th edition, effective 1st January 2018, updates effective 1st January 2021
- **FEI Driving and Para Driving Rules, 11th edition, effective 1st January 2014, updates effective 1st January 2021**
- Equine Anti-Doping and Controlled Medication Regulations (EADCMR), 3rd Edition, effective 1st January 2021
- FEI Anti-Doping Rules for Human Athletes (ADRHA), based upon the 2021 WADA Code, effective 1st January 2021
- The FEI Policy for Enhanced Competition Safety during the Covid-19 Pandemic, effective as of 1 July 2020 and until further notice
- Given the current Covid-19 situation, please note that the FEI's approval of a Schedule should not be taken as an absolute guarantee that the Event will definitely go ahead. The decision whether the Event can take place must be made by the OC and NF in close consultation with the applicable domestic government and public health authorities. It is the responsibility of each Participant to check the status of the Event prior to planning his/her travel to the Event.
- All subsequent published revisions, the provisions of which will take precedence.

THE ANNEXE(S) IS/ARE PART OF THIS APPROVED AND SIGNED SCHEDULE AND MUST BE DISTRIBUTED TO ALL OFFICIALS AND NFs AND IS AVAILABLE TO OTHERS UPON REQUEST

Approved by the FEI, Lausanne, on 04.10.2021, updated on 22.10.2021



Signature:
Manuel Bandeira de Mello
FEI Director Driving and Para Driving

NB: No modifications to the approved Schedule will be accepted less than two weeks prior to the event.

TABLE OF CONTENTS

I.	DENOMINATION OF THE EVENT	1
II.	GENERAL CONDITIONS	2
III.	THE FEI CODE OF CONDUCT FOR THE WELFARE OF THE HORSE	4
IV.	GENERAL INFORMATION	5
1.	ORGANISER.....	5
2.	ORGANISING COMMITTEE	5
3.	EVENT DIRECTOR.....	5
V.	OFFICIALS	6
VI.	INVITATIONS	7
4.	GENERAL	7
VII.	ENTRIES	7
1.	ENTRY DATES AND ENTRY FEES	7
2.	NO-SHOWS/LATE WITHDRAWALS:	8
3.	ADDITIONAL FEES/CHARGES BY ORGANISING COMMITTEE:	8
VIII.	TIMETABLE	9
IX.	COMPETITION DETAIL	9
1.	TYPE OF COMPETITIONS	9
2.	PRIZE MONEY	10
3.	"DRESSAGE" - COMPETITION	11
4.	"MARATHON" - COMPETITION	11
5.	"CONES" - COMPETITION	11
X.	FACILITIES OFFERED	12
1.	ATHLETES	12
2.	GROOMS	12
XI.	LOGISTICAL/ADMINISTRATIVE/TECHNICAL CONDITIONS	12
1.	DRAW	12
2.	COMPETITION ARENA(S).....	12
3.	PRACTICE ARENA(S).....	13
4.	STABLES	13
5.	TIMING DEVICE	13
6.	SCORING/TIMING PROVIDER.....	13
8.	PRIZE GIVING CEREMONY	14
9.	ADVERTISING ON ATHLETES AND HORSES	14
10.	TICKETING.....	14
11.	BETTING	14
12.	TRANSPORT REIMBURSEMENT HORSES/PONIES.....	14
13.	WELCOME	14
14.	LOCAL TRANSPORTATION - ARRANGEMENTS FROM HOTEL TO SHOW GROUNDS	14
15.	ENTRY RIGHT TO SHOWGROUNDS/ACCREDITED PERSONS	15
16.	LORRY / CARAVAN FACILITIES	15
17.	SUSTAINABILITY.....	15
XII.	VETERINARY MATTERS	16
1.	CUSTOMS FORMALITIES	16
2.	HEALTH REQUIREMENTS	16
3.	NATIONAL REQUIREMENTS	16
4.	PONIES	17
5.	INJURY SURVEILLANCE.....	17
6.	TRANSPORT OF HORSES	18
7.	VENUE ARRIVAL INFORMATION & FITNESS TO COMPETE	18
8.	EQUINE ANTI-DOPING AND CONTROLLED MEDICATION PROGRAMME	19
XIII.	HUMAN ANTI-DOPING	20
XIV.	ADDITIONAL INFORMATION	20
1.	THE FEI POLICY FOR ENHANCED COMPETITION SAFETY DURING THE COVID-19 PANDEMIC	20
2.	INSURANCES AND NATIONAL REQUIREMENTS	21
2.1.	ATHLETES, OWNERS AND SUPPORT PERSONNEL	21
2.2.	ATHLETES AND OWNERS	21
3.	PROTESTS/APEALS	22
4.	DISPUTES	22
5.	MODIFICATION TO SCHEDULE	22
6.	ADDITIONAL INFORMATION FROM THE ORGANISER.....	22
XV.	ANNEXES	24
1.	FEI ENTRY SYSTEM.....	24
2.	RESULTS.....	25

III. THE FEI CODE OF CONDUCT FOR THE WELFARE OF THE HORSE

The Fédération Equestre Internationale (FEI) expects all those involved in international equestrian sport to adhere to the FEI's Code of Conduct and to acknowledge and accept that at all times the welfare of the horse must be paramount and must never be subordinated to competitive or commercial influences.

1. At all stages during the preparation and training of competition horses, welfare must take precedence over all other demands. This includes good horse management, training methods, farriery and tack, and transportation.
2. Horses and Athletes must be fit, competent and in good health before they are allowed to compete. This encompasses medication use, surgical procedures that threaten welfare or safety, pregnancy in mares and the misuse of aids.
3. Events must not prejudice horse welfare. This involves paying careful attention to the competition areas, ground surfaces, weather conditions, stabling, site safety and fitness of the horse for onward travel after the event.
4. Every effort must be made to ensure that horses receive proper attention after they have competed and that they are treated humanely when their competition careers are over. This covers proper veterinary care, competition injuries, euthanasia and retirement.
5. The FEI urges all involved with the sport to attain the highest levels of education in their areas of expertise.

The Long version of this Code can be obtained from the Fédération Equestre Internationale, HM King Hussein I Building, Chemin de la Joliette 8, 1006 Lausanne, Switzerland. Telephone: +41 21 310 47 47. The Code is available in English. The Code is also available on the FEI's website: <http://inside.fei.org/>.

IV. GENERAL INFORMATION

1. ORGANISER

Name: Circuito Hípico del Sol - Sunshine Tour
Address: Dehesa Montenmedio. Carretera Nacional 340, Km.41.3 11150
Vejer de la Frontera (Cádiz-Spain)
Telephone: +34 956 447 125 / +34 649 293 273
Email: sunshinetour@sunshinetour.net
Website: www.sunshinetour.net

Contact Details Show Ground:

Address: Dehesa Montenmedio. Carretera Nacional 340, Km.41.3 11150
Vejer de la Frontera (Cádiz-Spain)

CODIGO DE EXPLOTACION O REGA: ES 110390000780 (IBERCOMPRA SA)

Telephone: +34 956 447 125 / +34 649 293 273

GPS Coordinates: Long 36.15 Lat -5.54 (Sunshine Tour)

Accessibility details (directions by road, nearest airport / train station): The venue is situated between Km. 41 to 42.5 of National Road 340 (E-5):

- Main entrance for trucks and participants is at Km 41.4.

- Nearest International Airports: Jerez de la Frontera (85 Km); Gibraltar (84 Km); Sevilla (160Km) & Málaga (195Km).

- Nearest Train Station: San Fernando-Bahía Sur (49 Km).

2. ORGANISING COMMITTEE

Honorary President: Mr. Antonio Blázquez Marín
President of the Event: Mr. Antonio Blázquez Marín
Show Secretary: Mrs. Begoña Quirós (Show Office)
Mrs. Vanesa Quirós (Accounting Office)
Press Officer: Mrs. Begoña Quirós

3. EVENT DIRECTOR

Name: Mrs. Teresa Blázquez Abascal
Address: Dehesa Montenmedio. Carretera Nacional 340, Km.41.3 11150
Vejer de la Frontera (Cádiz-Spain)
Telephone: +34 956 447 125
Mobile:
Email: sunshinetour@sunshinetour.net

FEI APPROVED SCHEDULE

CAI Vejer de la Frontera (ESP) 05-07.11.2021

V. OFFICIALS

* Compulsory

In case there are several categories and officials are not the same, please complete an additional chart per category.

Please note that as of 01.01.2019, Article 995 of the FEI Driving Rules regarding the rotation of Officials applies.

Ref.	Panel	Function	FEI ID	Name	NF	Level	Email/mobile *Compulsory
1	Ground Jury	Ground Jury President	10012537	Mr. Miguel Ángel Gutierrez Camarillo	ESP	3*	ma@quemadalesstables.es +34 609 54 71 41
		Ground Jury Member	10150027	Mr. Tiago Gomes	POR	2*	tiagogvet@gmail.com
		Ground Jury Member	10162333	Mr. Francisco Colmenero Gallardo	ESP	NAT	
		Ground Jury Member	10162332	Mr. José Manuel Alonso Luque	ESP	2*	jmalonso@grupoalonso.net
2	Foreign Judge	Foreign Judge	10051295	Mr. Jan-Erik Palsson	SWE	3*	
3	Technical Delegate	Technical Delegate	10052326	Mr. Joaquin Medina García	ESP	4*	joaquinmedinahipica@gmail.com
4	Assistant Technical Delegate	Assistant Technical Delegate					
5	Course Designer	Course Designer (3*)	10007501	Mr. Vilmos Jámbor	HUN	3*	
	Course Designer	Course Designer (2*)	10211028	Mr. Javier Pérez Maqueda	ESP	2*	jp.avj@hotmail.com
6	Assistant Course Designer						
8	Chief Steward	Chief Steward	10049316	Mr. Philip Bateman	GBR	2*	standish55@btinternet.com
9	Assistant Stewards	Assistant Steward	10094814 10096622	Mrs. M ^a Auxiliadora Carrión Lojo Mrs. ROOSILEHT, Pille-Riin	ESP HUNG	1*-	carriónauxi@gmail.com
		Assistant Steward					
10	FEI Veterinary Delegate	FEI Veterinary Delegate	10095054	Mrs. Isabel Cienfuegos Marco	ESP	3*	isabelcienfuegosm@hotmail.com +34 626 900 068
11	FEI Veterinary Delegate or Veterinary Commission	Veterinary Commission President					
		Assistant FEI Delegate					
		Assistant FEI Delegate					
11	Veterinary Service Manager (VSM) Treating Veterinarian (PTV)	Veterinary Service Manager	10150471	Mr. José Antonio Escobar Álvarez	ESP		cvlamuela@gmail.com +34680141974
		Permitted Treating Veterinarian	10150471	Mr. José Antonio Escobar Álvarez	ESP		cvlamuela@gmail.com +34680141974
12	Doctor / Medical Service	Doctor / Medical Service		Ambulancias Barbate	ESP		+34 956 447 125
13	Farrier	Farrier		Mr. Julio Guisado Rawas	ESP		+34 666 430 800
14	NF Delegate	NF Delegate (if applicable)					

VI. INVITATIONS

4. GENERAL

NFs invited (mandatory for CAI2* and above)	All Interested
Number of home drivers	All Interested
Number of foreign drivers	All Interested
Number of horses/ponies per driver	Single 1 / Pairs 2 / Four in Hand 5
Number of start per driver, per category	2

Competitors are invited by the Organizing Committee through their NF

VII. ENTRIES

IMPORTANT

- Entries must be made through the FEI Entry System for all categories of this event (<https://entry.fei.org>)
- Additional documentation can be found at: <https://inside.fei.org/fei/your-role/it-services/fei-entry-system/fei-entry-system-driving>
- All Athletes and Horses participating in any International competition must be registered with the FEI.
- Athletes and/or Horses present at the Event without having been entered through the FEI's Online Entry System will automatically be disqualified unless compelling circumstances warrant otherwise.

1. ENTRY DATES AND ENTRY FEES

Deadlines for Entries

Entries have to be in accordance with article 916 of the Driving rules and 116 of the General regulations

Definite entries:	30/09/2021
Last date for substitutions: (one hour prior the Horse Inspection) <i>Substitutions have to be in accordance with article 946.1.1 of the Driving rules</i>	Date :04/11/2021 Time :15:00

LIST OF COMPULSORY FEES:

• Entry Fee per Turnout	
Single	250€ (VAT included)
Pairs	350€ (VAT included)
Four-in-hand	500€ (VAT included)
• Stabling fee per horse/pony	

VAT:	21%
-------------	------------

• EADCMP Fee:	<input type="checkbox"/> Included in entry fee
	<input checked="" type="checkbox"/> Not included in entry fee

FEI APPROVED SCHEDULE

CAI Vejer de la Frontera (ESP) 05-07.11.2021



Lower Level Events (CIMs) (For definition of CIMs see Appendix E of the FEI General Regulations)	CHF 18 for Driving per turnout per event
Higher Level Events (All other events not defined as CIMs)	CHF 25 for Driving per turnout per event

Details entry procedure fee / Payment:	
All drivers accounts must be closed before departure.	

2. NO-SHOWS/LATE WITHDRAWALS:

NB: In the case of withdrawals after the date of definite entries or no-shows the athlete or the respective NF will be held liable to reimburse the OC for the actual financial loss incurred by the OC (i.e. stabling and hotel expenses) as a result of the late withdrawal or no-show.

Refund procedure:

Single: 250€ (VAT included)
Pairs: 350€ (VAT included)
Four in Hand: 500€ (VAT included)

3. ADDITIONAL FEES/CHARGES BY ORGANISING COMMITTEE:

All other fees must be listed hereunder with the details of the amounts to be charged and approved by the FEI. Only fees approved by the FEI and listed in the approved schedule can be charged by the Organiser.

Electricity for boxes (upon request):	
Manure disposal (maximum € 40 per horse per Event):	30.25€
Health/customs-related documents for Horses if applicable:	25€/health paper
Hay:	10,12€/bale
Straw:	6,60€/bale
Shavings:	11,07€/bale
Other (please specify):	
Empty stable/non competing horse:	60.50€

Lorry/Caravan:

Power supply:	provided by the OC <input checked="" type="checkbox"/>	Not provided by the OC <input type="checkbox"/>	Price: 90.00€
Water supply:	provided by the OC <input checked="" type="checkbox"/>	Not provided by the OC <input type="checkbox"/>	Price:
Sanitary facilities:	provided by the OC <input checked="" type="checkbox"/>	Not provided by the OC <input type="checkbox"/>	Price:
Catering facilities:	provided by the OC <input checked="" type="checkbox"/>	Not provided by the OC <input type="checkbox"/>	Price:

All aforementioned amounts are including VAT

VAT number of the Organiser	ES B41819673
-----------------------------	--------------

VIII. TIMETABLE

(to be provided per category/level if multiple events)

	Day	Date	Time
• Opening of stables	Wednesday	03/11/2021	10:00
• 1 st Horse Inspection: <i>All horses taking part at this event must be present during the first horse inspection, unless unable to do so due to "force majeure"</i>	Thursday	04/11/2021	16:00
• Declaration of Starters	Thursday	04/11/2021	After the 1 st Horse Inspection
• Dressage competition	Friday	05/11/2021	09:00
• Marathon	Saturday	06/11/2021	09:00
• Cones competition	Sunday	07/11/2021	10:00

IX. COMPETITION DETAIL

1. TYPE OF COMPETITIONS

International Competitions must not start before 8:00 and should not finish after 23:00 unless otherwise approved by the FEI.

CAI2* - three days	Format 1	Format 2
Please check the box	<input checked="" type="checkbox"/>	<input type="checkbox"/>
Day 1	Dressage	Dressage
Day 2	Marathon	Cones
Day 3	Cones	Marathon

CAI3*	Format 1	Format 2
Please check the box	<input checked="" type="checkbox"/>	<input type="checkbox"/>
Day 1	Dressage	Dressage
Day 2	Marathon	Cones
Day 3	Cones	Marathon

FEI APPROVED SCHEDULE

CAI Vejer de la Frontera (ESP) 05-07.11.2021

2. PRIZE MONEY

TOTAL PRIZE MONEY	EUR	CHF
225€	225€	

Breakdown of prize money – Combined Competition

PRIZE MONEY	EUR	CHF				
225€	225€					
Class	1 st place	2 nd place	3 rd place	4 th place	5 th place	Others
CAI3* H1	75€	50€	30€	20€	10€	6 th -10 th placed 10€

GENERAL CLASSIFICATION AT THE END OF THE COMPETITIONS

- Leading athlete award – (Prize description and value)
- Best foreign athlete - (Prize description and value)
- Best home athlete – (Prize description and value)
- Team awards – (Prize description and value)

PRIZE - CLASSIFICATION

The value of the 1st prize must not exceed 1/3 of the total prize money distributed for the competition. The minimum number of prizes offered for each competition must be allocated on the basis of one prize for every commenced four Athletes, with a minimum of five prizes.

Applicable government tax to be deducted from Prize Money: _____%

DEDUCTIONS FROM PRIZE MONEY AT COMPETITIONS:

Full details of any deductions from prize money must be outlined in the schedule. This includes government taxes. If it is necessary for Organisers to deduct such taxes, they must provide participants with an official form indicating the amount of tax deducted.

The tax form must be provided to the athletes upon arrival and returned to the Organiser prior to departing.

Space for organiser to include details if necessary

IMPORTANT

The total amount of prize money shown for each Competition in the schedule must be distributed. (FEI General Regulations articles 127 and 128)

3. "DRESSAGE" - COMPETITION

This competition will be in accordance with FEI Driving Rules

Dressage Test:

Event	Dressage Test
CAI3* H1-Single	3 HP1
CAI2* H2-Pairs	3B HP2
CAI2* H4-Four in Hand	3B HP4
CAI 2*- Children Ponies	Ch P1
CAI2 * H1 – Single	2 HP1
CAIJ2 * H1 – Single	Test J and YD

4. "MARATHON" - COMPETITION

This competition will be in accordance with FEI Driving Rules

Option 2:	Distance	Pace	Average Speed
Section A*	Controlled Warm up		
Section B	7500M	Free	14KM/H PONY 13KM/H

*Alternative option to phase A, Controlled Warm-up

Please indicate which option will be used:

- Controlled Warm-p
 Section A

Indicate the number of obstacles in Section B (per category): 7 Obstacles

5. "CONES" - COMPETITION

This competition will be in accordance with FEI Driving Rules

Type of Competition

*Fault Competition	<input checked="" type="checkbox"/>
Time Competition	<input type="checkbox"/>
Competition in two phases	<input type="checkbox"/>
Competition with Wining Round	<input type="checkbox"/>

*The score from this round will always be used solely to decide the Final Classification in all Events.

Please describe special obstacles: Oxer

X. FACILITIES OFFERED

1. ATHLETES

Accommodation

Hotel: Hipotels Gran Conil****

Address: C/Pleamar Nº 2 C.P.11140 Conil de la Frontera (Cádiz-Spain)

Telephone: +34 856 905 000 (Hotel) / +34 956 447 125 (Sunshine Tour)

GPS Coordinates: Lat 36.282842 Long -6.098732

Requests for accomodation: sunshinetour@sunshinetour.net

At the expense of: The Organiser or Athletes

Accommodated (bed and breakfast) from 03/11/2021 to 08/11/2021

Meals

At the expense of: The Organiser or Athletes

Meals provided from 03/11/2021 to 08/11/2021

2. GROOMS

Accommodation

Requests for accommodation must be sent with entries.

Accommodation will be at the cost of: Organiser Athletes

from 03/11/2021 to 08/11/2021.

Meals

At the expense of: The Organiser or Athletes

Meals provided from 03/11/2021 to 08/11/2021 .

NB. Organiser must provide proper sanitary conditions The showering facilities should be sufficient for both male and female grooms with hot and cold water. Shower facilities as well as restrooms should at all times be in a state of cleanliness.

XI. LOGISTICAL/ADMINISTRATIVE/TECHNICAL CONDITIONS

1. DRAW

Time, date and location: Physical Draw for Dressage, Reverse order of Standing after Dressage for Marathon and Cones in the show office the day before each class.

2. COMPETITION ARENA(S)

DRESSAGE ARENA

Length: 100 & 80 m

Width: 40 m

Type of Footing : Sand

CONES ARENA

Length: 120 m

Width: 70 m

Type of Footing : Grass

7. OTHER TECHNOLOGY/SERVICE PROVIDER(S)

NO

8. PRIZE GIVING CEREMONY

The number of athletes required to present themselves for the prize-giving ceremony of each competition is 3.

All Prize Giving Ceremonies must strictly follow the **Covid-19 guidelines for Prize giving protocols and media activities.**

9. ADVERTISING ON ATHLETES AND HORSES

Advertising in Dressage and Cones Competition: The competitors are: authorised not authorised (*please indicate*) by the OC to display the logo of their personal sponsor on the carriage in accordance with art. 135 of the General Regulations and Art. 941.1.

Advertising in Marathon Competition: The competitors are: authorised not authorised (*please indicate*) by the OC to display the logo of their personal sponsor on the marathon carriage and on the back(s) of the groom(s) in accordance with art. 135 of the General Regulations and Art. 941.2.

The Chief Steward will check that the advertising on athletes and horses complies with these Articles.

10. TICKETING

Are you selling ticket for spectator to attend your event: Yes No

Name of your ticketing provider:

Web address to buy ticket:

11. BETTING

Betting will be authorised by the Organiser: Yes No

12. TRANSPORT REIMBURSEMENT HORSES/PONIES

Transport expenses to be paid by:

The Organiser at _____ per km.

The Athlete

13. WELCOME

The time and date of arrival of athletes, horses and their means of transport must be given to the Organiser in order to facilitate their arrival.

14. LOCAL TRANSPORTATION - ARRANGEMENTS FROM HOTEL TO SHOW GROUNDS

Walking distance

Organiser Shuttle Service

Public Transport to be paid by the Organiser / the Athlete

Taxi to be paid by the Organiser / the Athlete

If paid by Athlete approximate cost per round trip:

Other:

15.ENTRY RIGHT TO SHOWGROUNDS/ACCREDITED PERSONS

**Entry right to the stable area according to FEI Veterinary Regulations
Articles 1008-1009.**

NUMBER OF ACCREDITED PERSONS:

Athlete: 1

Partner: 1

Groom: 2

Horse Owner: 2 two (2) accreditations per horse acc. to FEI-Passport

One groom per driver for Singles

One groom per driver for Pairs

Two grooms per driver for Four-in-Hands

16.LORRY / CARAVAN FACILITIES

Lorry or caravan can be parked close to the stables: Yes No

Square for OC to include additional details if necessary

17.SUSTAINABILITY

“Please consider the environment when organising an FEI Event. Please find useful information on FEI Sustainability here:” <http://inside.fei.org/fei/your-role/organisers/handbook>

XII. VETERINARY MATTERS

1. CUSTOMS FORMALITIES

Contact details for Customs Formalities:

Name: TRANSHIPICA INTERNATIONAL JESUS ESTEVEZ
Address: Asunción, 15. Brunete (Madrid-Spain)
Telephone: +34 918 158 276
Email: info@jesusestevez.com
Opening hours:

Space for organiser to include details if necessary

2. HEALTH REQUIREMENTS

GENERAL

In accordance with the FEI Code of Conduct for the Welfare of the horse it is imperative that all Horses at FEI Events are physically fit and free from infectious disease before being allowed to compete.

ENTRY OF HORSES

Required health tests and vaccinations
Quarantine period:
Specimen Import Licence applied:

For questions or problems, please contact your Government Veterinary Services.

Space for organiser to include details if necessary

3. NATIONAL REQUIREMENTS

If applicable please provide: UE Requirements

Absolutely necessary for Spanish Authorities:

1. Horses coming from the rest of Spain: Transport and health certificate.
2. Horses coming from EU: International Transport Certificate valid between EU members.
3. Horses coming from other countries: Valid Certificate which is required at the moment of entry.

Only for horses travelling from Spain:

CODIGO DE EXPLOTACION O REGA: ES 110390000780 (IBERCOMPRA SA)

Dehesa Montenmedio

Carretera Nacional 340, Km.41.3

11150 Vejer de la Frontera (Cádiz-España)

When you enter the Sunshine Tour you must be able to submit the correct transport documents / health papers for each horse to the Show Office at your arrival. The OC reserves the right to deny access when these legally valid documents cannot be displayed.

4. PONIES

FEI Veterinary Regulations, Chapter IX and Annex IX:

For all Pony Events, Ponies must be available for Pony Measurement if requested by the FEI.

5. INJURY SURVEILLANCE

FEI Veterinary Regulations, Chapter VIII:

Horses participating in FEI Events are subject to injury surveillance protocols; and in the event of fatality, a post mortem examination.

6. TRANSPORT OF HORSES

Horses must be fit to travel and be transported in suitable vehicles. Any government requirements for disease testing and control must be requested well in advance, to ensure that the horse is in compliance by the time of arrival at the border of the country where the Event is taking place. Athletes, or their representatives, have the responsibility to comply with national legislation in both their country of origin and the host nation of the Event. Where necessary athletes must contact local government authorities or veterinary advisors for information regarding animal health requirements and transport legislation. Within the European Union (EU), this includes EU Council Regulation (EC) No 1/2005 concerning the protection of animals during transport within the Member States of the EU

7. VENUE ARRIVAL INFORMATION & FITNESS TO COMPETE

7.1 PASSPORTS. FEI General Regulations Article 137

For all issues relating to FEI Horse Passports/FEI Recognition Cards please contact your National Federation

All Horses competing at FEI Events must be registered with the FEI.

FEI Passports or FEI Recognition Cards (for those Horses with a national passport approved by the FEI) are compulsory for FEI Events.

NB: Horses entered in CIMs in their country of residence are not required to have an FEI Passport or FEI Recognition Card but must be properly registered with the FEI and identifiable (GRs 137.2).

Athletes who do not present a Horse's Passport and/or Recognition Card, or one that is not correctly validated, or fail to meet other passport requirements will be **subject to Sanctions in accordance with Annex VI of the Veterinary Regulations** and may not be allowed to compete.

NB for Horses permanently resident in a Member State of the European Union: all Horses must have a national EU passport in compliance with EU Regulations to which a FEI Recognition card is applied. The exception to this being Horses in possession of an FEI passport which has been continually revalidated without interruption.

7.2 VACCINATIONS - EQUINE INFLUENZA. FEI Veterinary Regulations Article 1003

Horses competing at FEI Events must comply with the requirements for Equine Influenza vaccination in accordance with the Veterinary Regulations and as summarised below.

VACCINATION	PROTOCOL	ELIGIBILITY TO ENTER VENUE
Primary Course	1 st Vaccination: day 0 2 nd Vaccination: day 21-92	May compete 7 days after the 2 nd Vaccination
First Booster	Within 7 months of the 2 nd vaccination of the Primary Course	May compete for 6 months +21 days after the 2 nd vaccination of the Primary Course Must not compete in the 7 days after receiving a vaccination
Boosters	MINIMUM: within one year of previous booster vaccination IF COMPETING: must be in the 6 months +21 days of the booster previous vaccination	Must have been vaccinated within 6 months +21 days before arriving at the Event Must not compete in the 7 days after receiving a vaccination

All FEI registered Horses intending to compete at FEI Events (including CIMs) must be vaccinated against Equine Influenza in accordance with these VRs. The exception being if the applicable domestic legislation prevents the use of Equine Influenza vaccines within the relevant territory.

7.3 EXAMINATION ON ARRIVAL. FEI Veterinary Regulations Article 1031

On arrival at an Event venue all Horses must undergo an examination by a veterinarian to confirm their identification from their passport and micro-chip ID (where present), their vaccination status and general health. To protect all horses attending events, any Horse with a questionable health status concerning vaccination, disease or other concerns, must be stabled within the isolation facilities provided by the Organising Committee pending a decision on entering the venue.

7.4 HORSE INSPECTIONS. FEI Veterinary Regulations Articles 1034-1042

All Horses will be assessed for their fitness to compete during the Horse Inspection. Any Horse demonstrating questionable fitness may be referred to the Holding Box for further veterinary examination. Horses not deemed fit to compete by the Inspection Panel will not be permitted to compete.

7.5 LIMB SENSITIVITY EXAMINATION. FEI Veterinary Regulations Articles 1048-1053

All Horses are subject to examination under the protocol for abnormal limb sensitivity throughout the period of an Event.

For Jumping that includes, but is not limited to, between rounds and before the Jump Off. For Endurance that includes, but is not limited to, pre-ride, during the ride and after the ride. Horses may be examined once or on multiple occasions during the Period of an Event.

Horses may be selected for examination under the protocol randomly or they may be targeted. All Horses selected to be tested must submit promptly to the examination or are subject to immediate disqualification. There is no obligation to examine any specific number of Horses at an Event.

8. EQUINE ANTI-DOPING AND CONTROLLED MEDICATION PROGRAMME (EADCMP). FEI Veterinary Regulations, Chapter VII

8.1. SAMPLING. FEI VETERINARY REGULATIONS Chapter VII

All horses competing at FEI Events may be subject to sampling for the presence of Prohibited Substances in accordance with the Anti-Doping and Controlled Medication Regulations (EADCMRs). Horses may be selected for sampling in accordance with obligatory testing, targeted or random sampling procedures. Refer to FEI Financial Charges for details of fees relating to Equine and Human Anti-Doping program (EADCMP), which OCs/NFs have the right to charge to the athlete (applicable for all FEI events worldwide).

8.2. ELECTIVE TESTING. FEI VETERINARY REGULATIONS ARTICLE 1058

Elective Testing may be carried out prior to an Event to check for the presence of Prohibited Substances. Please refer to <https://inside.fei.org/fei/cleansport/horses> for information and details.

XIII. HUMAN ANTI-DOPING

Athletes can be tested at any FEI Event, by the FEI or by other Anti-Doping Organisations with Testing jurisdiction. Organisers will have the responsibility to provide facilities and staff/volunteers to facilitate such Testing if requested by the FEI as outlined in article 22.3 of the FEIs' Anti-doping Rules for Human Athletes (ADRHA)

The ADRHA rules are published on the FEI's website at <http://inside.fei.org/content/anti-doping-rules>

XIV. ADDITIONAL INFORMATION

1. THE FEI POLICY FOR ENHANCED COMPETITION SAFETY DURING THE COVID-19 PANDEMIC

The FEI Policy for Enhanced Competition Safety during the Covid-19 Pandemic ("Policy") <https://inside.fei.org/fei/covid-19/return-to-play/policy-tools> is mandatory and applies for any FEI Event taking place **as of 1 July 2020**. The Policy has been developed based on currently accepted best practices by the WHO and US Center for Disease Control (CDC) and will be continually reviewed and updated as more information becomes available. It is not intended to replace the applicable guidance and policies from domestic government and health authorities, but to supplement their recommendations with sport specific considerations.

The OC shall submit the risk assessment and mitigation plan (including name and contact details of the person in charge) to the FEI as an annex to the Event Schedule, **at the latest ten (10) working days before the event's deadline for Definite Entries.**

Events for which the FEI has not received the documented risk assessment and mitigation measures plan in accordance with article 2.1.g) of the Policy **will be removed from the FEI calendar** in accordance with Article 112.3 of the FEI General Regulations.

ASSUMPTION OF RISK / WAIVER OF LIABILITY

In consideration of being allowed to participate in the Event and related activities, all Participants (as defined in the Policy) acknowledge, appreciate, and agree that:

1. Participation includes possible exposure to and illness from infectious diseases including but not limited to COVID-19. While particular rules and personal discipline may reduce this risk, the risk of serious illness and death does exist; and,
2. The Participants knowingly and freely assume all such risks, both known and unknown, even if arising from the negligence of the OC or others, and assume full responsibility for their participation; and,
3. The Participants willingly agree to comply with the stated and customary terms and conditions for participation as regards protection against infectious diseases. If, however, a Participant observes any unusual or significant hazard during his/her presence or participation, the Participant will remove himself/herself from participation and bring such to the attention of the nearest official immediately; and,
4. The Participants, for themselves and on behalf of their heirs, assigns, personal representatives and next of kin, HEREBY RELEASE AND HOLD HARMLESS THE OC AND THE FEI, their officers, officials, agents, and/or employees, other participants, sponsoring agencies, sponsors, advertisers, and if applicable, owners

and lessors of premises used to conduct the event ("RELEASEES"), WITH RESPECT TO ANY AND ALL ILLNESS, DISABILITY, DEATH, or loss or damage to person or property, WHETHER ARISING FROM THE NEGLIGENCE OF RELEASEES OR OTHERWISE, to the fullest extent permitted by law.

The Participants confirm to have read this release of liability and assumption of risk agreement, fully understand its terms, understand that they have given up substantial rights.

2. INSURANCES AND NATIONAL REQUIREMENTS

Equestrian sports involve inherent dangerous risks. To the greatest extent permitted by law, the FEI and the FEI Event Organiser shall NOT be liable for any damages relating to loss of property or injury of any kind to Athletes, Owners, Support Personnel or Horses at or in connection with an FEI Event and the FEI expressly excludes all such liability.

2.1. ATHLETES, OWNERS AND SUPPORT PERSONNEL

2.1.1. Personal Accident and Health Insurance

It is your responsibility as an Athlete/Owner/ Support Personnel to ensure that you have adequate personal accident insurance in place to cover your participation at FEI Events and in particular to insure against any personal injury or medical expenses arising from an accident, injury or illness which may occur at a FEI Event.

You should check with your National Federation to confirm if your National Federation's insurance policy (if any) covers personal accidents and/or illnesses which may occur when you are attending/participating in FEI Events.

If your National Federation does not have a personal accident/health insurance policy or if the National Federation's insurance policy does not cover personal accident or health claims, then you should obtain your own personal accident and health insurance policy to cover your attendance/participation at FEI Events.

2.1.2. Personal Property Insurance

You should also ensure that you are insured against property loss, theft or damage which may occur at an FEI Event.

Again, the advice is to check with your National Federation to confirm if they have an insurance policy in place which would cover you in case of such property loss, theft or damage. If not, then you should obtain your own personal property insurance to cover such situations.

2.1.3. Press Equipment

Press equipment and other items left in the Press workroom, Press lockers, the Press Tribune or anywhere on the showgrounds are left entirely at the owner's risk. The Organising Committee does not accept any responsibility for any loss or damage to such equipment or items. Members of the Press are advised not to leave any equipment or personal items unattended.

2.2. ATHLETES AND OWNERS

2.2.1. Third Party Liability Insurance

As an Athlete/Owner you are personally responsible for damages to third parties caused by you, your employees, Support Personnel, your agents or your Horses. You are, therefore, strongly advised to take out third-party liability insurance providing full coverage in relation

to FEI Events at home and abroad, and to keep the policy up to date.

The FEI and the Organiser will NOT be responsible for any damage caused to third parties by you, your employees, Support Personnel, your agents or your Horses.

2.2.2. Additional Liability Information

Space for organiser to include reference to National Laws when necessary

2.2.3. Horse Insurance

As an Owner you should ensure that your Horses are adequately insured against any injuries or illnesses they may sustain while participating at a FEI Event.

Space for organiser to include reference to National Laws when necessary

3. PROTESTS/APPEALS

To be valid, all Protests and Appeals must be made in writing and accompanied by a deposit of CHF 150.- or equivalent.

Protest and appeal forms are available on the FEI website.

Protests: <http://inside.fei.org/sites/default/files/FEI%20Protest%20Form.pdf>

Appeals: <http://inside.fei.org/sites/default/files/FEI%20Appeal%20Form.pdf>

4. DISPUTES

In the event of any discussion concerning the interpretation of the schedule (in translated languages), the English version will be decisive.

5. MODIFICATION TO SCHEDULE

In exceptional circumstances, together with the approval of Chefs d'Equipe, host NF delegate, if any, and Ground Jury, the Organiser may change the schedule in order to clarify any matter arising from an omission or due to unforeseen circumstances. Any such changes must be notified to all athletes and officials as soon as possible and they must be reported to the FEI Secretary General by the Foreign Judge.

6. ADDITIONAL INFORMATION FROM THE ORGANISER

Space for organiser to include reference to National Laws when necessary

Minimum Age Limitation for Athletes and Grooms – Article 912:

Senior Classes		Athlete Minimum Age
Horses Four-in-Hand		18 years
Horse Pairs		16 years
Horse Single		14 years
All Pony Classes		14 years
Young Drivers Classes		Athlete Minimum Age
Horses Four-in-Hand		18-21 years
Horse Pairs		16-21 years
Horse Single		16-21 years
All Pony Classes		16-21 years
Juniors Classes		Athlete Minimum Age
Horse Pairs		16-18 years
Horse Single		14-18 years
All Pony Classes		14-18 years
Children Class		Athlete Minimum Age
Single Pony		12-14 years
Grooms	Minimum Age	
All Classes	Athletes under the age of 18 years must be accompanied by a groom(s) of 18 years or older. Athletes of 18 years and above must be accompanied by a groom(s) of 14 years or older.	
Children	The groom must be over 18 years old. The NF must ensure that the groom must be knowledgeable and experienced in Driving.	

Minimum Age Limitation for Horses – Article 929:

Horses	Minimum Age
CAI1*	5 years old or over
CAI2* and above	6 years old or over

XV. ANNEXES

1. FEI ENTRY SYSTEM

Please fill the form below in order to provide you and the other members of your committee or your IT Providers access to the FEI Entry System.

FEI ID¹: 10114813
Name*: BEGOÑA
First Name*: QUIROS CABRERA
E-Mail*: office@sunshinetour.net
Access Rights*: Admin² Consult³

Events⁴:

FEI ID¹:
Name*:
First Name*:
E-Mail*:
Access Rights*: Admin² Consult³

Events⁴:

FEI ID¹:
Name*:
First Name*:
E-Mail*:
Access Rights*: Admin² Consult³

Events⁴:

¹ If already have an FEI user account.
² Provides you the required access to manage entries and substitutions and download entries/lists.
³ You are just able to consult and download the entries/lists.
⁴ Leave the field blank if the user deals with the entries of all events in the show.
*** Mandatory Fields**

2. RESULTS

An online results interface is available to manage Driving results <http://forms.fei.org>

All results must be submitted to the FEI via this online platform or by uploading XML results file(s) directly on FEI Database. For additional information please browse to:

<http://www.fei.org/fei/your-role/organisers/driving/results-forms>

In order to proceed with the results publication and for qualification purposes the FEI requires results to be uploaded within five days after the conclusion of the event.

Please note that as per Art. 109.6 (GR): Failure from OCs of International Events to provide the FEI with the appropriate result(s) and/or prize money information by the aforesaid deadline and/or in the aforesaid format shall entail a warning for the first violation and thereafter a fine of CHF 1'000.- per violation.

The FEI may request a copy of the official PDF result signed by the relevant Officials at the Event

All results must include FEI Passport Registration number of horses and FEI ID number of Riders.

THE APPENDIX IS PART OF THIS APPROVED AND SIGNED SCHEDULE AND MUST BE DISTRIBUTED TO ALL OFFICIALS AND NFs AND IS AVAILABLE TO OTHERS UPON REQUEST